



Fig.6



For Technical Support:

Call our Technical Service Department
Monday through Friday, 9 a.m. to 5 p.m. (EST)

1-800-832-8697

customer_support@enablingdevices.com

Clip Clamp #3706

USER'S GUIDE



50 Broadway
Hawthorne, NY 10532
Tel. 914.747.3070 / Fax 914.747.3480
Toll Free 800.832.8697
www.enablingdevices.com

Easy mounting!

A great item for holding items at eye level including eye-talks, photographs or icons. You can easily mount this to wheelchair trays, tabletops or bedrails. Includes 24" gooseneck, super clamp and hand clamp. Size: 27"H. Weight: 2¼ lbs.

1. **Clamping Options:** Our mounting clamp is designed for mounting to tubular (wheelchair, bedrail, walker, etc.) or flat surfaces such as a table top or desk. For flat surface mounting use the included wedge insert shoe stored in front of the locking knob on the clamp (see Fig.1 & 2) Loosen locking knob slightly to remove wedge, tighten knob once wedge has been removed.



Fig.1



Fig. 2

1. Using the mounting clamp, attach the Clip Clamp to a Wheel Chair, Table or Desk. Tighten the clamp enough to hold the Clip Clamp securely, but do not over-Tighten the clamp.

2. For some mounting applications the clamp will need to be mounted horizontally, we have included a Gooseneck clamp mount adapter for this use. To use the adapter you first must remove the Gooseneck from the clamp, do this by loosening the set knob on the back of the clamp. This is the same knob that holds the clamp wedge (shown in Fig.1). Next depress the spring loaded pin on the side of the clamp and pull the Gooseneck from the clamp (see Fig.3). Attach the adapter to the Gooseneck and secure with the included mounting screws as shown in (Fig. 4 & 5).



Fig.3

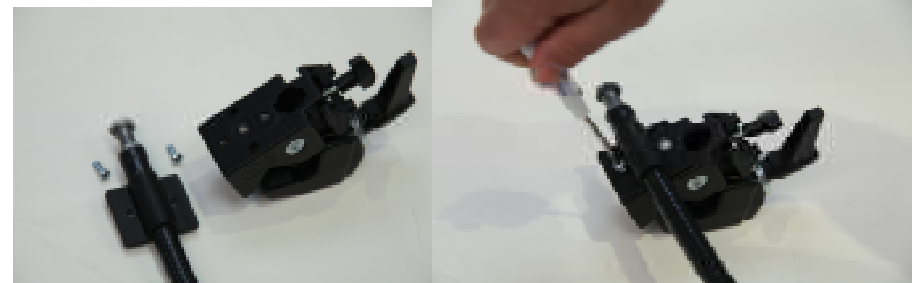

Fig.4

Fig.5

Care of Unit:

Clip Clamp can be wiped clean with any household multi-purpose cleaner and disinfectant. We recommend Simple Green, which is a non toxic biodegradable all-purpose cleaner.

Do not use abrasive cleaners, as they will scratch the surface of the unit.