Ultimate Switch #1671, 1552 & 1551

USER'S GUIDE



For Technical Support:

Call our Technical Service Department
Monday through Friday, 9 a.m. to 5 p.m. (EST)
1-800-832-8697
customer_support@enablingdevices.com



50 Broadway
Hawthorne, NY 10532
Tel. 914.747.3070 / Fax 914.747.3480
Toll Free 800.832.8697
www.enablingdevices.com

Our #1 best selling Switch!

Our exclusive Ultimate Switch is THE most universal, versatile, multi-faceted switch. It's designed to be used by even the most profoundly challenged or neurologically impaired individuals. It requires only the slightest touch for activation (10 grams of force), yet can easily withstand the abuse of gross body movements or severe blows. 19" Gooseneck and universal clamp included. Weight: 2½ lbs.

Operation:

1. Using the mounting clamp, attach the Ultimate Switch to a Wheel Chair, Table or Desk. Tighten the clamp enough to hold the Ultimate Switch securely, but do not over-Tighten the clamp. (See Photos).
2. Plug the Ultimate Switch into your switch adapted toy/device. Make sure that the connection is tight. There should be NO gaps. If you use an adapter for devices with ¼ inch jacks, make sure that it is a MONO adapter, not stereo.
3. Actuate the Ultimate switch in order to turn on your toy/device. Your toy/device will only remain activated while you hold the Ultimate switch in the actuated position. Once you release pressure on the Ultimate switch, the toy/device will turn off.

Troubleshooting:

Problem #1: The toy/device is not activating.

Action #1: Make sure that the connection to the toy/device is very tight. There should be NO gaps. Make sure that you are using a MONO adapter, if applicable.

Action #2: Try using your toy/device with a different switch in order to rule out the toy/device as the source of the problem. You may need to change the batteries in the toy/device.

Care of Unit:

The Ultimate Switch can be wiped clean with any household multi-purpose cleaner and disinfectant. We recommend Simple Green, which is a non toxic biodegradable all-purpose cleaner.

Do not submerge the unit, as it will damage the electrical components.

Do not use abrasive cleaners, as they will scratch the surface of the unit.

1. **Clamping Options:** Our mounting clamp is designed for mounting to tubular (wheelchair, bedrail, walker, etc.) or flat surfaces such as a table top or desk. For flat surface mounting use the included wedge insert shoe stored in front of the locking knob on the clamp (see Fig.1 & 2) Loosen locking knob slightly to remove wedge, tighten knob once wedge has been removed.



Fig.1



Fig. 2

2. Using the mounting clamp, attach the Ultimate Switch to a Wheel Chair, Table or Desk. Tighten the clamp enough to hold the Ultimate Switch securely, but do not over-Tighten the clamp.

3. For some mounting applications the clamp will need to be mounted horizontally, we have included a Gooseneck clamp mount adapter for this use. To use the adapter you first must remove the Gooseneck from the clamp, do this by loosening the set knob on the back of the clamp. This is the same knob that holds the clamp wedge (shown in Fig.1). Next depress the spring loaded pin on the side of the clamp and pull the Gooseneck from the clamp (see Fig.3). Attach the adapter to the Gooseneck and secure with the included mounting screws as shown in (Fig. 4 & 5).



Fig.3

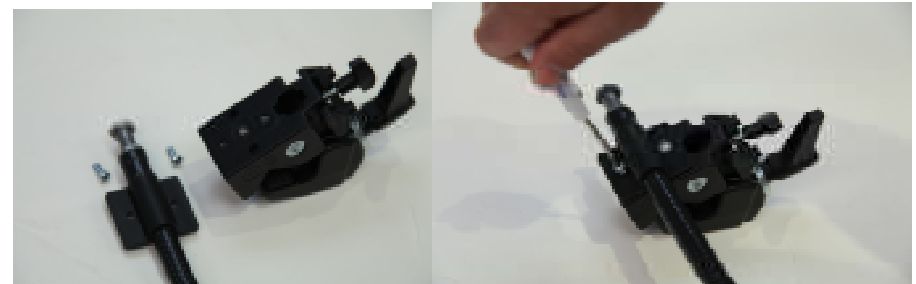

Fig.4

Fig.5